

Wanna Wanga!

Roy's saber parts shop

DV6 ROTJ Graflex Stunt (MoM)

EXPLODED VIEW

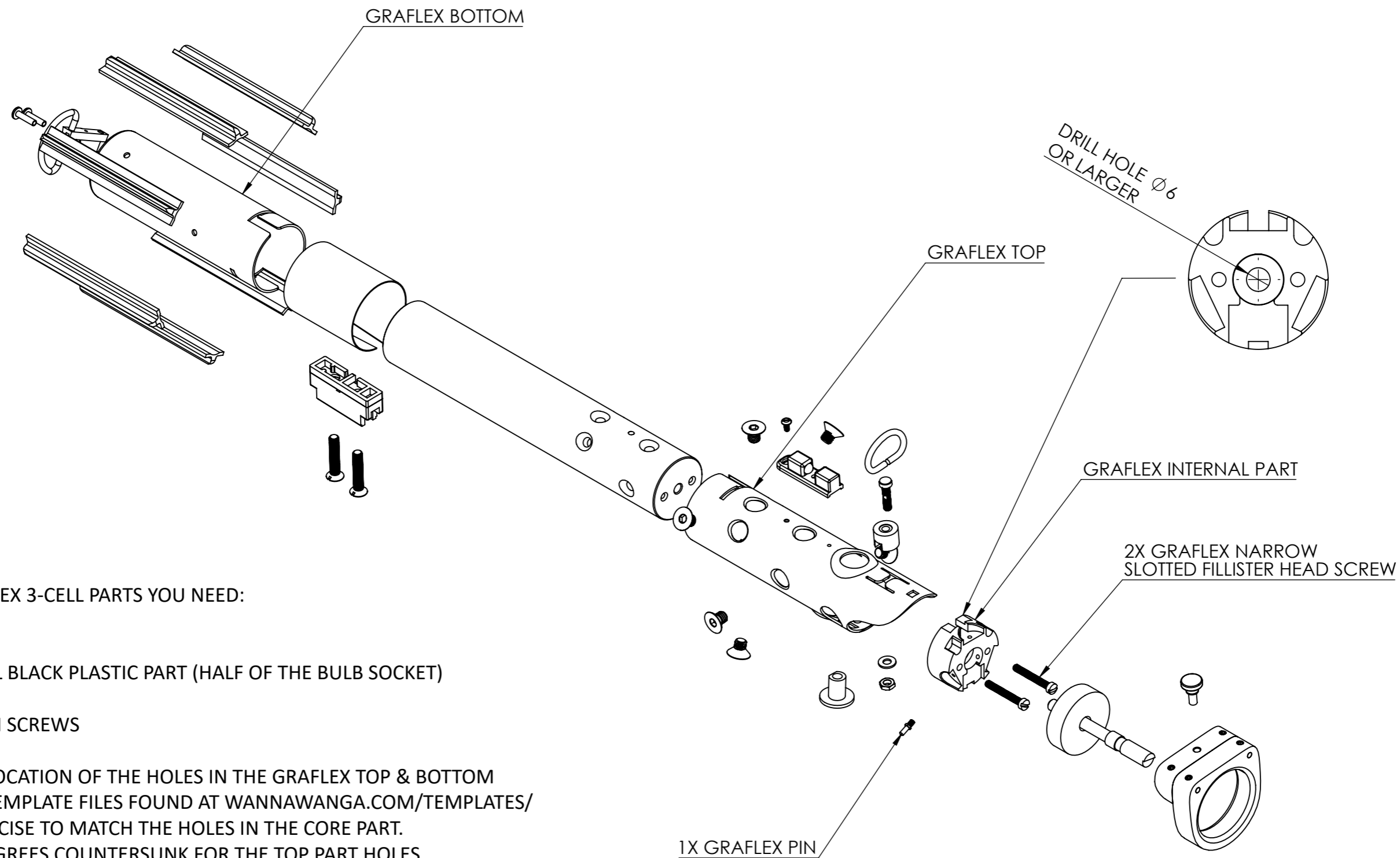

THE GRAFLEX 3-CELL PARTS YOU NEED:

- TOP
- BOTTOM
- INTERNAL BLACK PLASTIC PART (HALF OF THE BULB SOCKET)
- 1X PIN
- 2X 1 INCH SCREWS

FOR THE LOCATION OF THE HOLES IN THE GRAFLEX TOP & BOTTOM
USE THE TEMPLATE FILES FOUND AT WANNAWANGA.COM/TEMPLATES/
WORK PRECISE TO MATCH THE HOLES IN THE CORE PART.
USE 90 DEGREES COUNTERSUNK FOR THE TOP PART HOLES.